

Installing the SPARCstation Voyager Memory Cards



About the Memory Card

SPARCstation™ Voyager™ systems are equipped with a minimum of 16 megabytes of random access memory (RAM). Additional memory can be added to your system as needed in 16- or 32-megabyte increments, up to a maximum of two memory cards. This memory card plugs into a memory slot located on the CPU board.

Unpacking the Memory Card

When you remove a memory card from the shipping box, you should have:

- This document
- The memory card
- An antistatic wrist strap
- Three plugs (keep them as spares)

Store the box and its packaging material for future use.

Powering Off the System

Note - Do not suspend the system prior to installing a memory card. You must power the system off.

1. Become superuser by typing `su`.
2. Type your superuser password.
3. Type `init 0`.
The screen will display messages that end with an `ok` prompt.
4. Turn off the power to any external units.
External units can include external drives, printers, or other serial or parallel devices. See the instructions supplied with the device.
5. Press the Shift and power (⏻) keys to turn off the system.

6. Disconnect the keyboard cable from the system.
7. Disconnect the AC power cord from the wall outlet and the power supply.
8. Disconnect cables to any external units.
See the document supplied with each device.

Opening the System

1. Slide the power supply door to the unlock position.

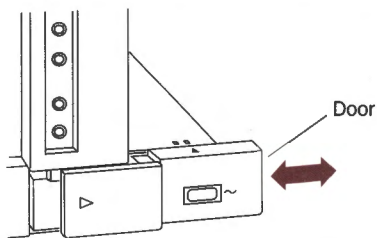

2. Grasp the door to pull the power supply out of the tunnel.

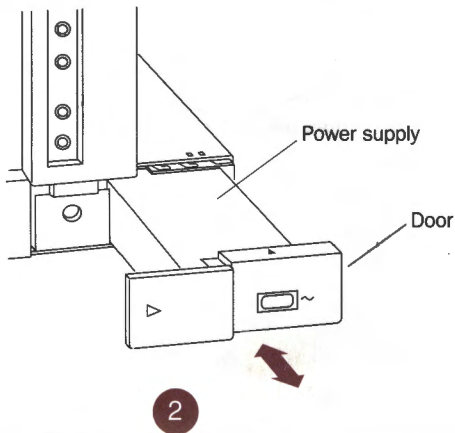

- Use a paper clip to puncture the center of the rubber plug and remove the plug from the left cap.
- Loosen the two screws on the left cap.
- Slide the left cap off the unit.

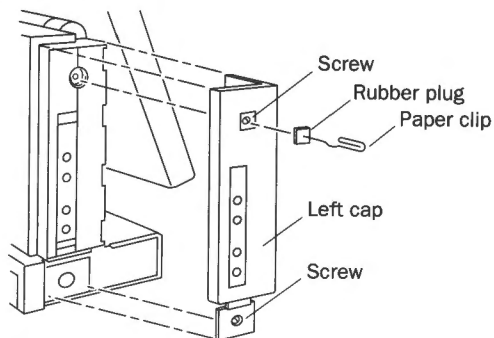

- Remove both rubber plugs from the right cap.
- Loosen the two screws holding the right cap of the unit.
- Slide the right cap off the unit.

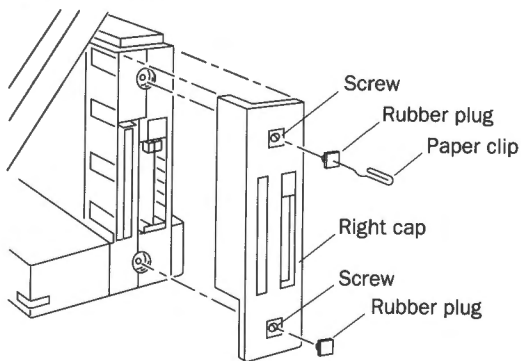

9. Hold both ends of the rear cover, slide it back, and then lift it up away from the unit.

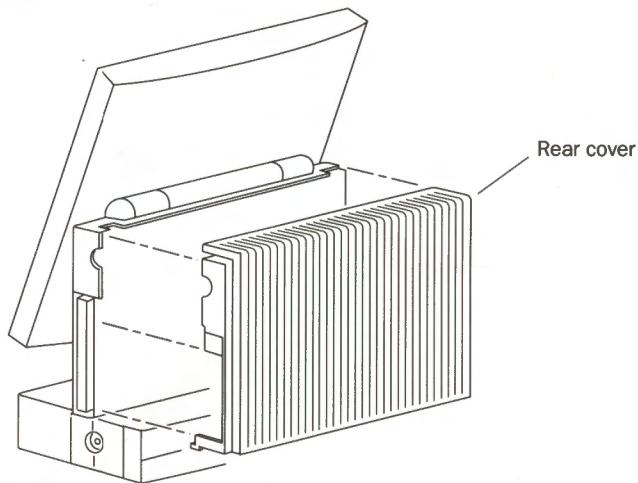

Caution - Surfaces may be hot. Do not touch these surfaces.

Attaching the Wrist Strap

1. Unwrap the first two folds of the wrist strap. Wrap the adhesive side firmly around your wrist.
2. Peel away the liner from the copper foil at the opposite end of the wrist strap and attach the end to the metal part of the system, next to the memory card slots.

Installing the Memory Card

1. With the wrist strap on, take the memory card out of its packaging.
2. Push the memory card all the way into either of the open slots. The Sun logo on the memory card should be facing out. The memory card is keyed, so it fits one way only.

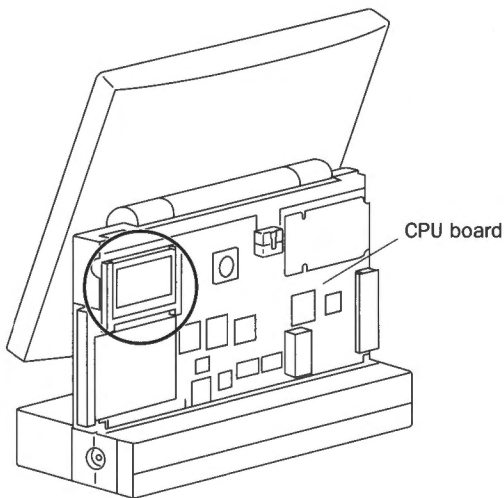
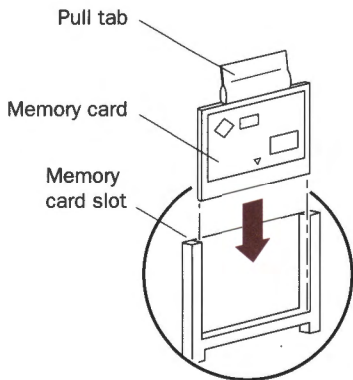

3. Tuck the pull tab behind the memory card.
4. Remove the wrist strap.

Closing the System

1. Hold both ends of the rear cover and slide it in.
2. Hold the front and rear covers together and replace the right cap on the unit.
3. Tighten the two screws to secure the right cap.
4. Insert both plugs into the right cap.
5. Hold the front and rear covers together and replace the left cap on the unit.
6. Tighten the two screws to secure the left cap.
7. Insert the plug in the left cap.
8. Insert the power supply into the tunnel, and slide it in.
9. Slide the door to the locked position.

Powering On the System

1. Connect the keyboard cable into the keyboard port.
2. Connect the AC power cord to the power supply and to the wall outlet.
3. Connect the cables to the external units.
See the document supplied with each device.
4. Turn on the power for the external units starting with the unit farthest electrically from the system.
The external units can include external drive units, printers, or other serial or parallel devices.
5. Press the power key (⏻) on the system keyboard.
The system will reboot.

© 1994 Sun Microsystems, Inc.
2550 Garcia Avenue, Mountain View, California 94043-1100 U.S.A.

All rights reserved. This product and related documentation are protected by copyright and distributed under licenses restricting its use, copying, distribution, and decompilation. No part of this product or related documentation may be reproduced in any form by any means without prior written authorization of Sun and its licensors, if any.

Portions of this product may be derived from the UNIX® and Berkeley 4.3 BSD systems, licensed from UNIX System Laboratories, Inc. and the University of California, respectively. Third-party font software in this product is protected by copyright and licensed from Sun's Font Suppliers.

RESTRICTED RIGHTS LEGEND: Use, duplication, or disclosure by the United States Government is subject to the restrictions set forth in DFARS 252.227-7013 (c)(1)(ii) and FAR 52.227-19.

The product described in this manual may be protected by one or more U.S. patents, foreign patents, or pending applications.

TRADEMARKS

Sun, Sun Microsystems, Sun Microsystems Computer Corporation, the Sun logo, the Sun Microsystems Computer Corporation logo, and SPARCstation Voyager are trademarks or registered trademarks of Sun Microsystems, Inc. UNIX and OPEN LOOK are registered trademarks of UNIX System Laboratories, Inc. All other product names mentioned herein are the trademarks of their respective owners.

All SPARC trademarks, including the SCD Compliant Logo, are trademarks or registered trademarks of SPARC International, Inc. SPARCstation, SPARCserver, SPARCengine, SPARCworks, and SPARCcompiler are licensed exclusively to Sun Microsystems, Inc. Products bearing SPARC trademarks are based upon an architecture developed by Sun Microsystems, Inc.

THIS PUBLICATION IS PROVIDED "AS IS" WITHOUT WARRANTY OF ANY KIND, EITHER EXPRESS OR IMPLIED, INCLUDING, BUT NOT LIMITED TO, THE IMPLIED WARRANTIES OF MERCHANTABILITY, FITNESS FOR A PARTICULAR PURPOSE, OR NON-INFRINGEMENT.

THIS PUBLICATION COULD INCLUDE TECHNICAL INACCURACIES OR TYPOGRAPHICAL ERRORS. CHANGES ARE PERIODICALLY ADDED TO THE INFORMATION HEREIN; THESE CHANGES WILL BE INCORPORATED IN NEW EDITIONS OF THE PUBLICATION. SUN MICROSYSTEMS, INC. MAY MAKE IMPROVEMENTS AND/OR CHANGES IN THE PRODUCT(S) AND/OR THE PROGRAM(S) DESCRIBED IN THIS PUBLICATION AT ANY TIME.